

A57 Link Roads TR010034

2.4 Streets, Rights of Way and Access Plans

APFP Regulation 5(2)(k)

Planning Act 2008 Infrastructure Planning (Applications: Prescribed
Forms and Procedure) Regulations 2009



Infrastructure Planning Planning Act 2008

The Infrastructure Planning (Applications: Prescribed Forms and Procedure) Regulations 2009

A57 Link Roads Scheme

Development Consent Order 202[x]

2.4 STREETS, RIGHTS OF WAY AND ACCESS PLANS

Regulation Number:	Regulation 5(2)(k)
Planning Inspectorate Scheme Reference	TR010034
Application Document Reference	TR010034/APP/2.4
Author:	A57 Link Roads Scheme Project Team, Highways England

Version	Date	Status of Version
Rev 1.0	June 2021	DCO Application

Table of contents

Chapter	Pages
1. Introduction	4
1.1 Introduction and purpose of this document	4
1.2 Scope and format of the Streets, Rights of Way and Access Plans	4
2. Schedule of plans included in this application document	5

1. Introduction

1.1 Introduction and purpose of this document

- 1.1.1 Highways England (the “Applicant”) has applied to the Secretary of State for Development Consent Order (“DCO”) to determine the Applicant’s proposals for the creation of new link roads and alteration to the existing A57; A57 Link Roads (the “Scheme”). The application is submitted to the Planning Inspectorate (the “Inspectorate”) in accordance with section 37 of the Planning Act 2008 (the “2008 Act”).
- 1.1.2 This document comprises part of the suite of Application documents and is submitted to comply with Regulation 5(2)(k) of the Infrastructure Planning (Applications: Prescribed Forms and Procedure) Regulations 2009 (as amended), which requires:
- 5(2)(k) ‘where applicable, a plan identifying any new or altered means of access, stopping up of streets or roads or any diversions, extinguishments or creation of rights of way or public rights of navigation’.*
- 1.1.3 The purpose of the Streets, Rights of Way and Access Plans is to show streets, roads and public rights of way that are to be stopped up, diverted or extinguished and new highways, including public rights of way to be created and their intended highway classification. The Plans also show private means of access to be stopped-up, extinguished or altered and the substitute means of access to be provided. The Streets, Rights of Way and Access Plans have been prepared having regard to best practice and advice provided by the Planning Inspectorate under Section 51 of the Planning Act 2008.
- 1.1.4 The Streets, Rights of Way and Access Plans are submitted for approval and will be certified under article 45 of the DCO once the Order is made. As this document is part of a suite of Application documentation, it should be read alongside and is informed by other Application documents. In particular, the plans should be read alongside the Book of Reference (application document TR010034/APP/4.3) and Schedule 3 and 4 of the of the Development Consent Order (application document reference TR010034/APP/3.1)

1.2 Scope and format of the Streets, Rights of Way and Access Plans

- 1.2.1 This document should be read alongside and is informed by the other Application documents, in particular:
- Draft Development Consent Order [TR010034/APP/3.1]
 - Schedule 3: Classification of Roads etc. [TR010034/APP/3.1]
 - Schedule 4: Permanent Stopping Up Of Highways And Private Means Of Access & Provision Of New Highways And Private Means Of Access. [TR010034/APP/3.1]

2. Schedule of plans included in this application document

Document title	Document number	Version
2.4 Streets, Rights of Way and Access Plan – Key Plan Regulation 5(4)	TR010034/APP/2.4 HE551473-BBA-LDC-A57_AL_SCHEME-DR-ZL-020400	P01
2.4 Streets, Rights of Way and Access Plan – Sheet 1 of 10 Regulation 5(2)(k)	TR010034/APP/2.4 HE551473-BBA-LDC-A57_AL_SCHEME-DR-ZL-020401	P01
2.4 Streets, Rights of Way and Access Plan – Sheet 2 of 10 Regulation 5(2)(k)	TR010034/APP/2.4 HE551473-BBA-LDC-A57_AL_SCHEME-DR-ZL-020402	P01
2.4 Streets, Rights of Way and Access Plan – Sheet 3 of 10 Regulation 5(2)(k)	TR010034/APP/2.4 HE551473-BBA-LDC-A57_AL_SCHEME-DR-ZL-020403	P01
2.4 Streets, Rights of Way and Access Plan – Sheet 4 of 10 Regulation 5(2)(k)	TR010034/APP/2.4 HE551473-BBA-LDC-A57_AL_SCHEME-DR-ZL-020404	P01
2.4 Streets, Rights of Way and Access Plan – Sheet 5 of 10 Regulation 5(2)(k)	TR010034/APP/2.4 HE551473-BBA-LDC-A57_AL_SCHEME-DR-ZL-020405	P01
2.4 Streets, Rights of Way and Access Plan – Sheet 6 of 10 Regulation 5(2)(k)	TR010034/APP/2.4 HE551473-BBA-LDC-A57_AL_SCHEME-DR-ZL-020406	P01
2.4 Streets, Rights of Way and Access Plan – Sheet 7 of 10 Regulation 5(2)(k)	TR010034/APP/2.4 HE551473-BBA-LDC-A57_AL_SCHEME-DR-ZL-020407	P01
2.4 Streets, Rights of Way and Access Plan – Sheet 8 of 10 Regulation 5(2)(k)	TR010034/APP/2.4 HE551473-BBA-LDC-A57_AL_SCHEME-DR-ZL-020408	P01
2.4 Streets, Rights of Way and Access Plan – Sheet 9 of 10 Regulation 5(2)(k)	TR010034/APP/2.4 HE551473-BBA-LDC-A57_AL_SCHEME-DR-ZL-020409	P01
2.4 Streets, Rights of Way and Access Plan – Sheet 10 of 10 Regulation 5(2)(k)	TR010034/APP/2.4 HE551473-BBA-LDC-A57_AL_SCHEME-DR-ZL-020410	P01

DO NOT SCALE

Millimetres

0 10

100

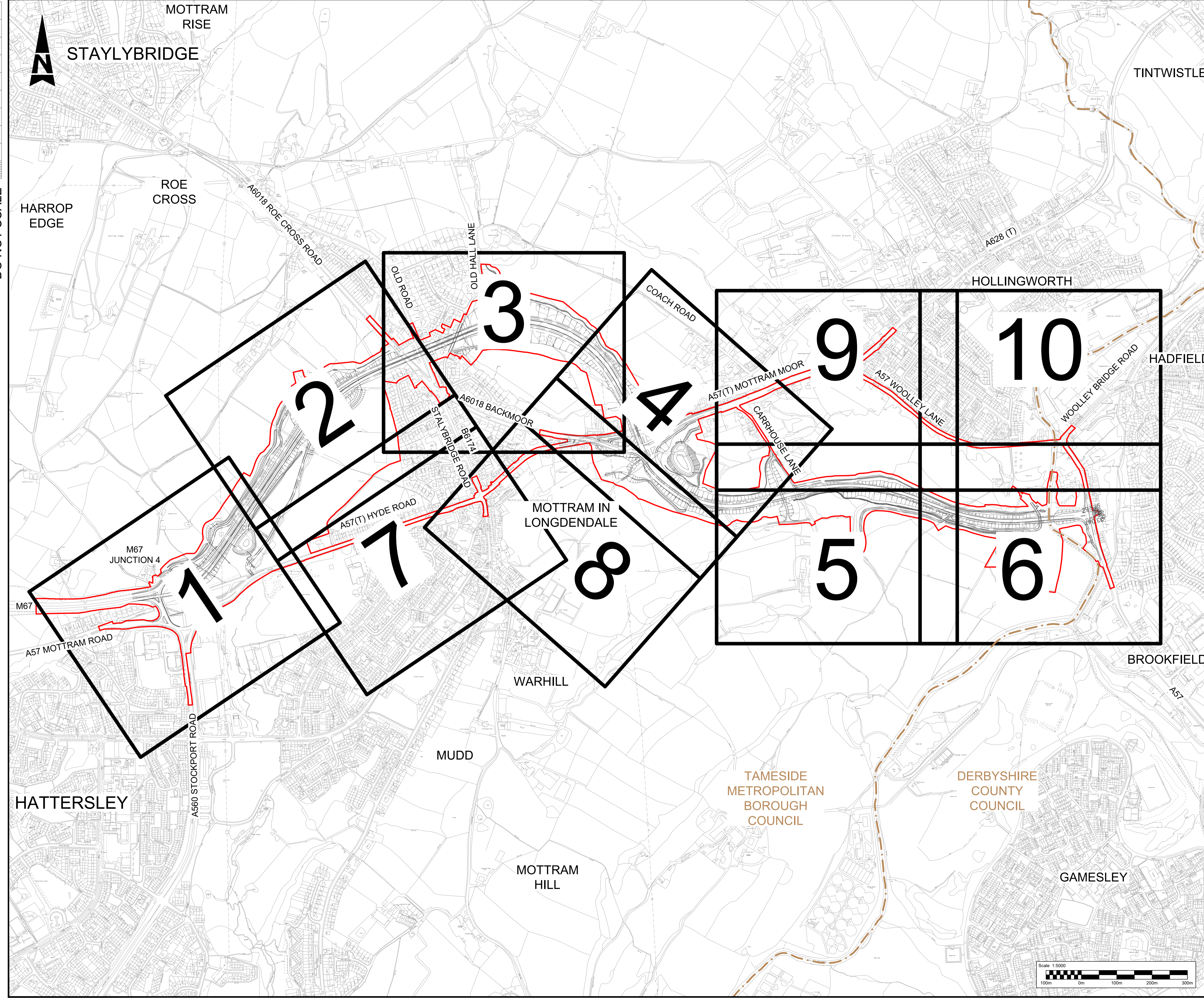

NOTES

1. THE PROPOSED WORKS WILL BE SUBJECT TO DETAILED DESIGN DEVELOPMENT. ANY CHANGES WILL BE LIMITED TO BEING WITHIN THE DCO BOUNDARY OR THE RELEVANT LIMITS OF DEVIATION, AND SUBJECT TO THE REQUIREMENTS OF SCHEDULE 2 OF THE DEVELOPMENT CONSENT ORDER (TR010034/APP/3.1).

LEGEND

3 SHEET NUMBER FOR PROPOSED WORKS TO STREETS, RIGHTS OF WAY, AND ACCESSES SHOWN IN THIS AREA.

— DEVELOPMENT CONSENT ORDER (DCO) BOUNDARY

- - - LOCAL AUTHORITY BOUNDARY

This map is based on Ordnance Survey material with the permission of Ordnance Survey on behalf of the Controller of Her Majesty's Stationary Office. © Crown copyright. Unauthorised reproduction infringes Crown copyright and may lead to prosecution or civil proceedings. Highways England 100030640, 2021.

Description	Status	Revision	Issue Date
DCO APPLICATION	A4	P01	14/05/21
DCO APPLICATION	Status A4		

Client:

Scheme Name: **A57 LINK ROADS**

Drawing Title: **STREETS, RIGHTS OF WAY AND ACCESS KEY PLAN REGULATION 5(4) SHEET 1 OF 1**

PINS Ref No: TR010034/APP/2.4

Drawing Number	Originator	Volume
HE551473	BBA	LDC
Location	Type	Role
A57_AL_SCHEME	DR	ZL
Scale	Original Size	Rev
1:5000 @ A1	A1	P01

DO NOT SCALE

Millimetres
0 10 100

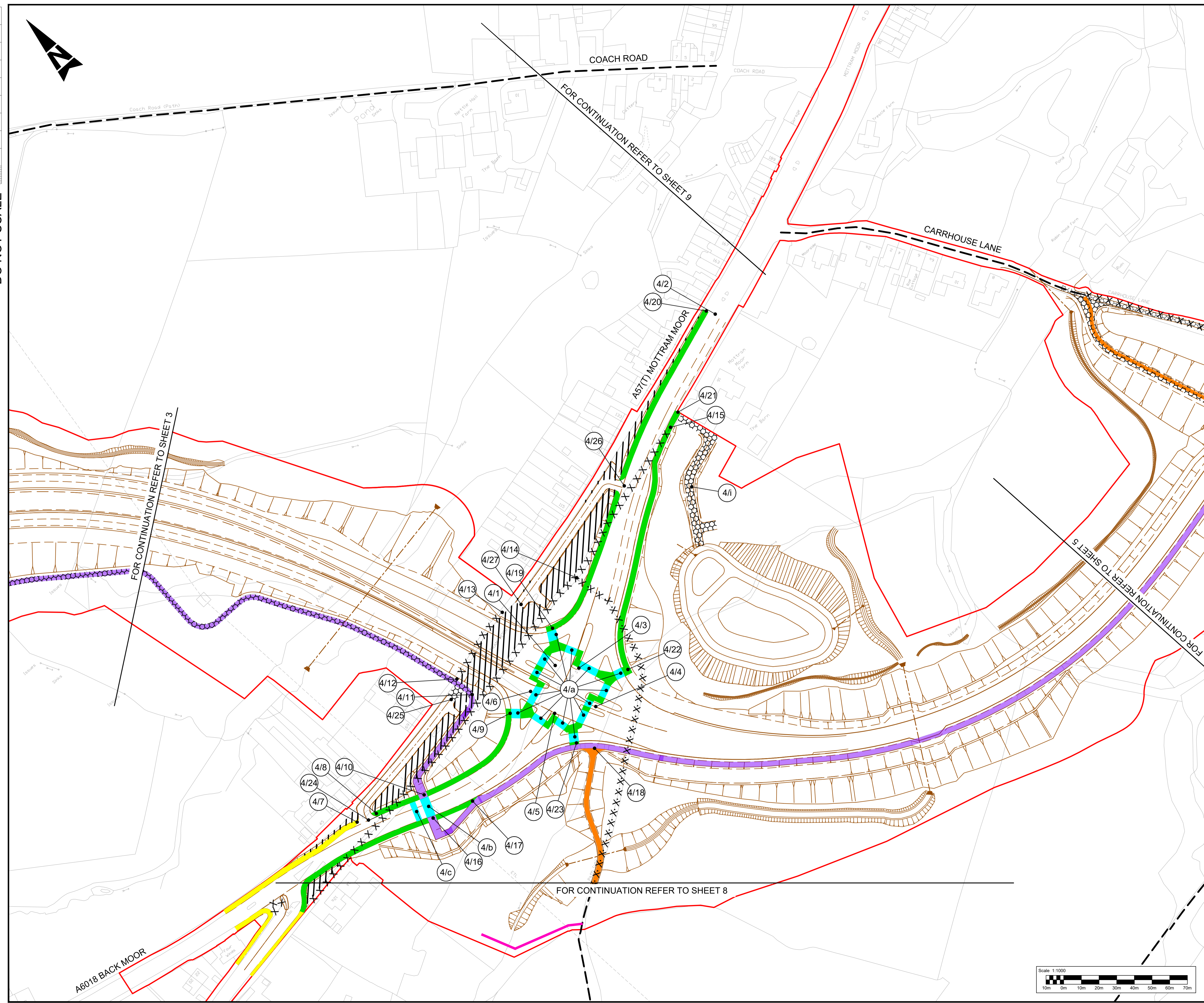
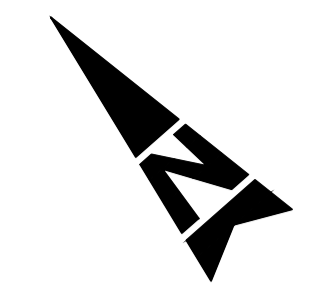

Notes

- These plans should be read in conjunction with Schedules 3 and 4 of the Development Consent Order (application document reference TR010034/APP/3.1).

Legend:

- Local Authority boundary
- Development Consent Order (DCO) boundary
- Scheme layout (shown for illustrative purposes)
- Existing highways to be stopped up
- Private means of access to be stopped up
- New/alterd private means of access
- Existing Public Right of Way (PRoW)
- PRoW or footway/cycleway to be stopped up/extinguished
- New or diverted bridleway
- New or diverted footway
- New or diverted footpath
- New non-segregated footway/cycle track
- New private means of access to maintain ecology mitigation

8/2 Start/End point of highway / right of way to be improved, diverted, created, stopped up or extinguished

1/a New signal controlled non-motorised user crossing

A Existing private means of access to be stopped up

9/i Other private means of access to be altered

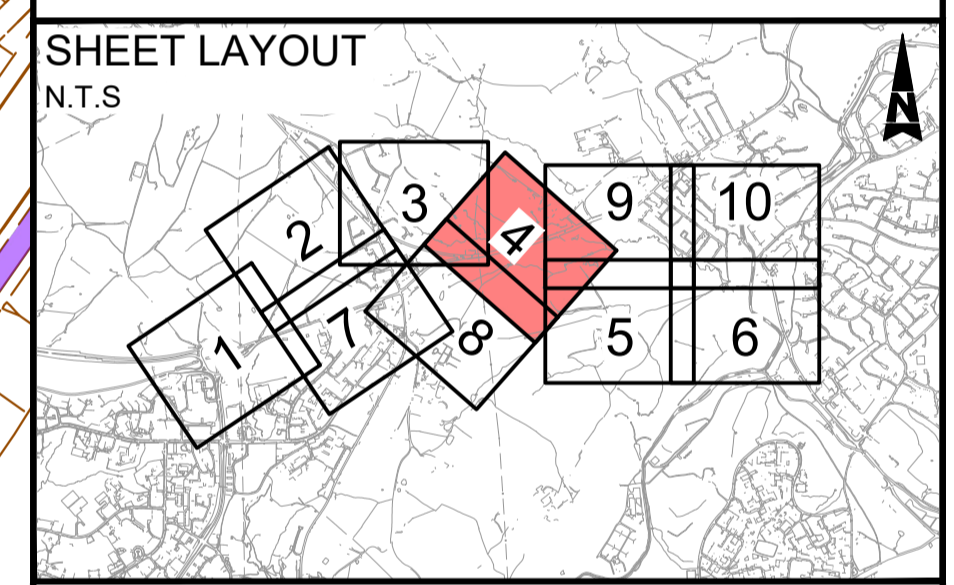

This map is based on Ordnance Survey material with the permission of Ordnance Survey on behalf of the Controller of Her Majesty's Stationary Office. © Crown copyright. Unauthorised reproduction infringes Crown copyright and may lead to prosecution or civil proceedings. Highways England, 100030640, 2021.

Description	Status	Revision	Issue Date

DCO APPLICATION

Status	A4	Revision	P01	Issue Date	14/05/21
Drawing Suitability	DCO APPLICATION			Status	A4



Client	highways england					
Scheme Name	A57 LINK ROADS					
Drawing Title	STREETS, RIGHTS OF WAY AND ACCESS PLANS REGULATION 5(2)(k) SHEET 4 OF 10					
PINS Ref No:	TR010034/APP/2.4					
Drawing Number	HE551473	Originator	BBA	Volume	LDC	
Location	A57_AL_SCHEME		Type	DR	Role	ZL
Scale:	1:1000 @ A1	Original Size:	A1	Rev:	P01	

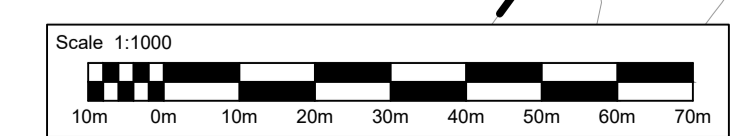

DO NOT SCALE

Millimetres
0 10 100

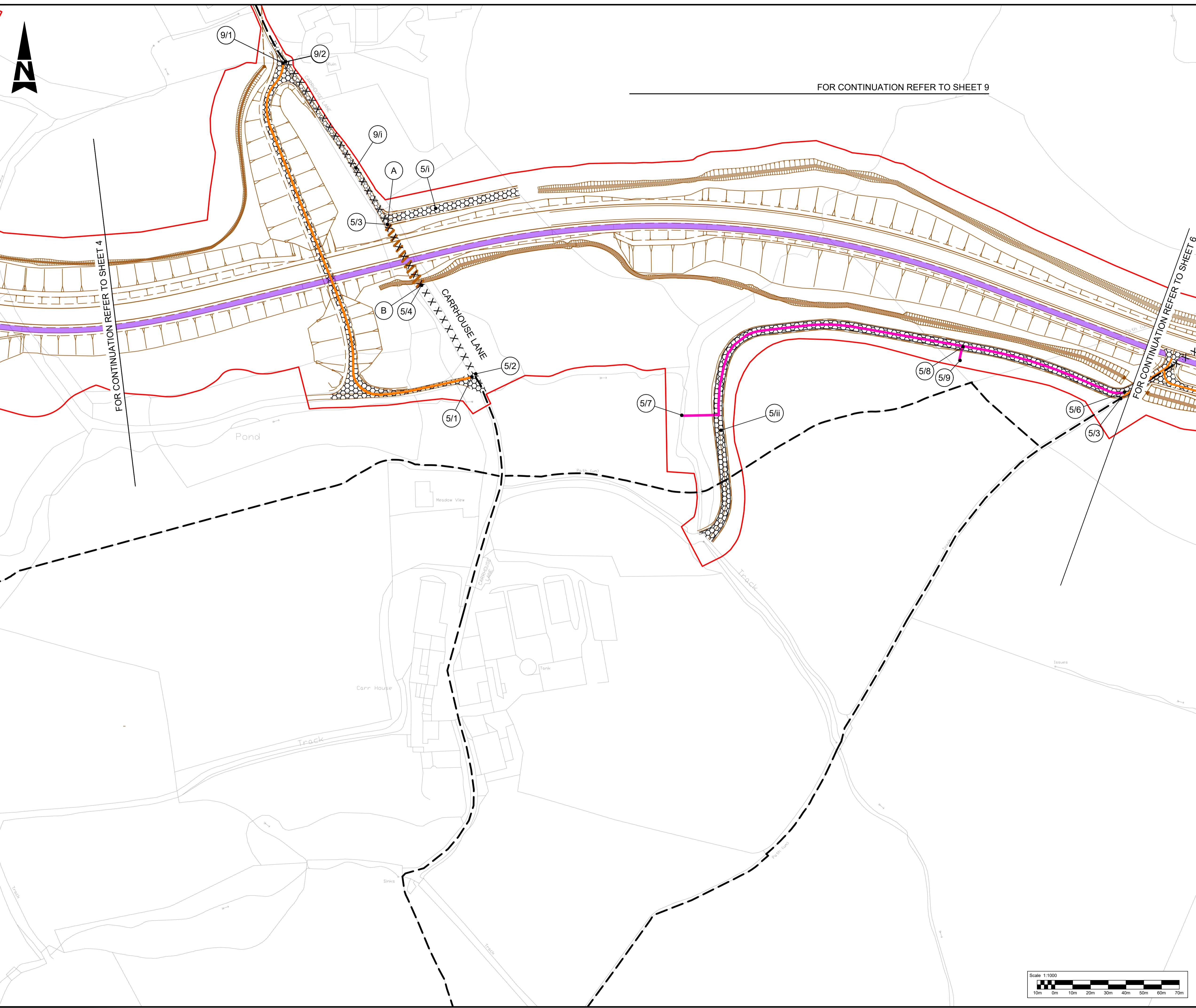

FOR CONTINUATION REFER TO SHEET 9

FOR CONTINUATION REFER TO SHEET 4

FOR CONTINUATION REFER TO SHEET 6

Notes

- These plans should be read in conjunction with Schedules 3 and 4 of the Development Consent Order (application document reference TR010034/APP/3.1).

Legend:

- Local Authority boundary
- Development Consent Order (DCO) boundary
- Scheme layout (shown for illustrative purposes)
- Existing highways to be stopped up
- Private means of access to be stopped up
- New/alterd private means of access
- Existing Public Right of Way (PRoW)
- PRoW or footway/cycleway to be stopped up/extinguished
- New or diverted bridleway
- New or diverted footway
- New or diverted footpath
- New non-segregated footway/cycle track
- New private means of access to maintain ecology mitigation
- Start/End point of highway / right of way to be improved, diverted, created, stopped up or extinguished
- New signal controlled non-motorised user crossing
- Existing private means of access to be stopped up
- Other private means of access to be altered

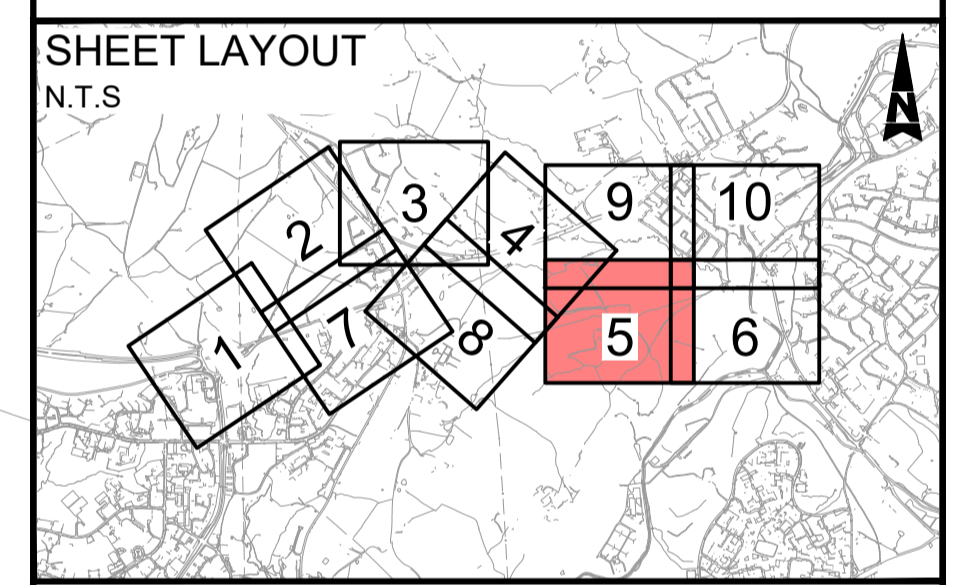

This map is based on Ordnance Survey material with the permission of Ordnance Survey on behalf of the Controller of Her Majesty's Stationery Office. © Crown copyright. Unauthorised reproduction infringes Crown copyright and may lead to prosecution or civil proceedings. Highways England 10003649, 2021.

Description	Status	Revision	Issue Date

Description	Status	Revision	Issue Date
DCO APPLICATION	A4	P01	14/05/21

Drawing Suitability	Status
DCO APPLICATION	A4



Scheme Name
A57 LINK ROADS

Drawing Title
**STREETS, RIGHTS OF WAY AND ACCESS PLANS
REGULATION 5(2)(k)
SHEET 5 OF 10**

PINS Ref No:
TR010034/APP/2.4

Drawing Number
Scheme: HE551473 | Originator: BBA | Volume: LDC
A57_AL_SCHEME | DR | ZL | 020405

Location	Type	Role	Number
Scale: 1:1000 @ A1	Original Size: A1	Rev: P01	

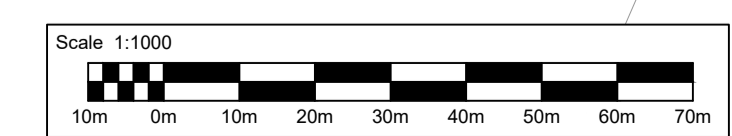

DO NOT SCALE

Millimetres
0 10 100

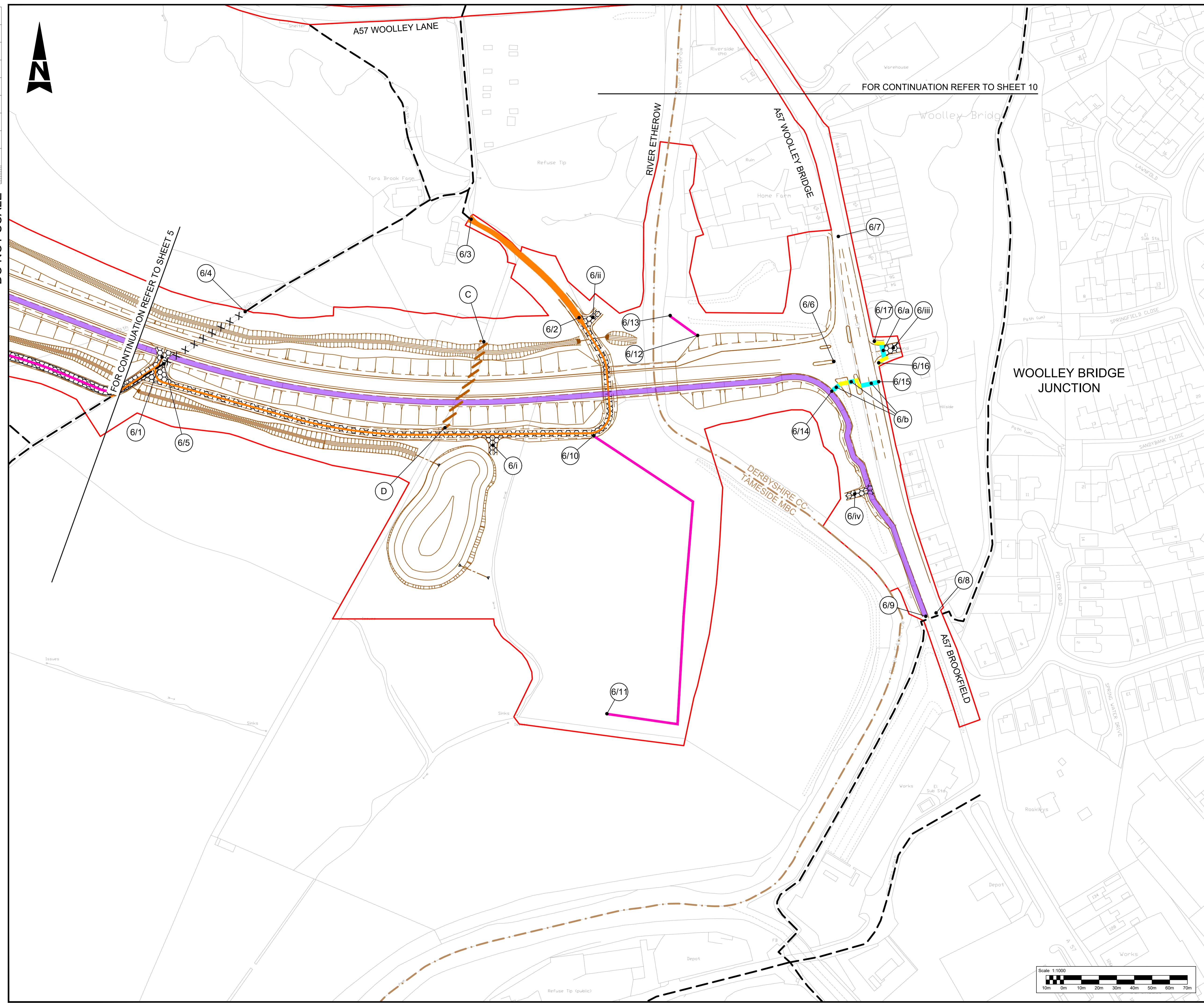
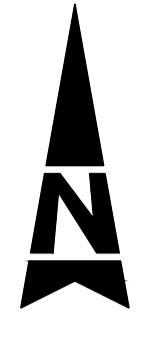

FOR CONTINUATION REFER TO SHEET 10

FOR CONTINUATION REFER TO SHEET 5

Notes

- These plans should be read in conjunction with Schedules 3 and 4 of the Development Consent Order (application document reference TR010034/APP/3.1).

Legend:

- Local Authority boundary
- Development Consent Order (DCO) boundary
- Scheme layout (shown for illustrative purposes)
- Existing highways to be stopped up
- Private means of access to be stopped up
- New/alterd private means of access
- Existing Public Right of Way (PRoW)
- PRoW or footway/cycleway to be stopped up/extinguished
- New or diverted bridleway
- New or diverted footway
- New or diverted footpath
- New non-segregated footway/cycle track
- New private means of access to maintain ecology mitigation
- Start/End point of highway / right of way to be improved, diverted, created, stopped up or extinguished
- New signal controlled non-motorised user crossing
- Existing private means of access to be stopped up
- Other private means of access to be altered

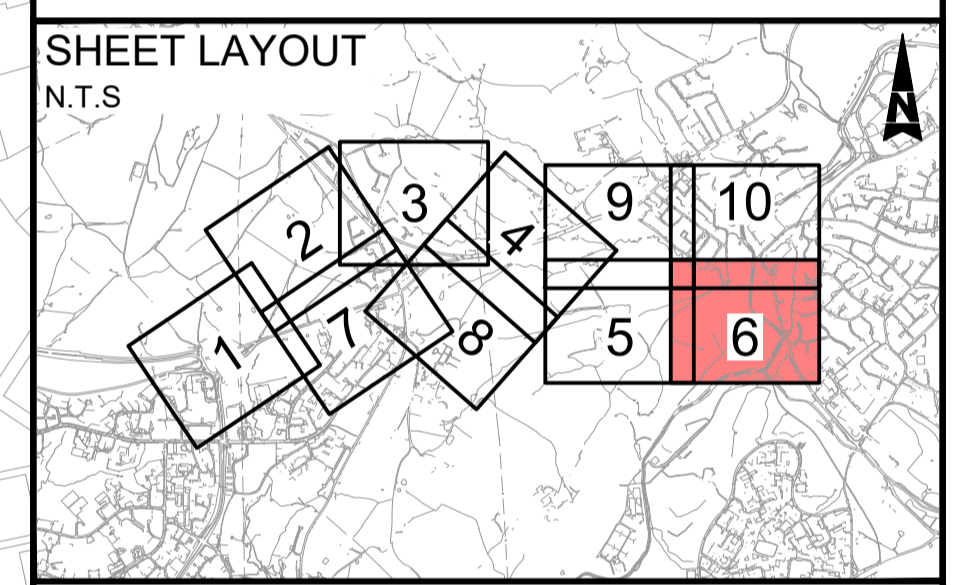

This map is based on Ordnance Survey material with the permission of Ordnance Survey on behalf of the Controller of Her Majesty's Stationary Office. © Crown copyright. Unauthorised reproduction infringes Crown copyright and may lead to prosecution or civil proceedings. Highways England, 100030649, 2021.

Description	Status	Revision	Issue Date

DCO APPLICATION			Status
Status	A4	Revision	P01
Issue Date	14/05/21		A4



Scheme Name
A57 LINK ROADS

Drawing Title
STREETS, RIGHTS OF WAY
AND ACCESS PLANS
REGULATION 5(2)(K)
SHEET 6 OF 10

PINS Ref No:
TR010034/APP/2.4

Drawing Number HE551473	Originator BBA	Volume LDC
Location A57_AL_SCHEME	Type DR	Role ZL
Scale 1:1000 @ A1	Original Size A1	Rev P01



DO NOT SCALE

Millimetres

0 10

100

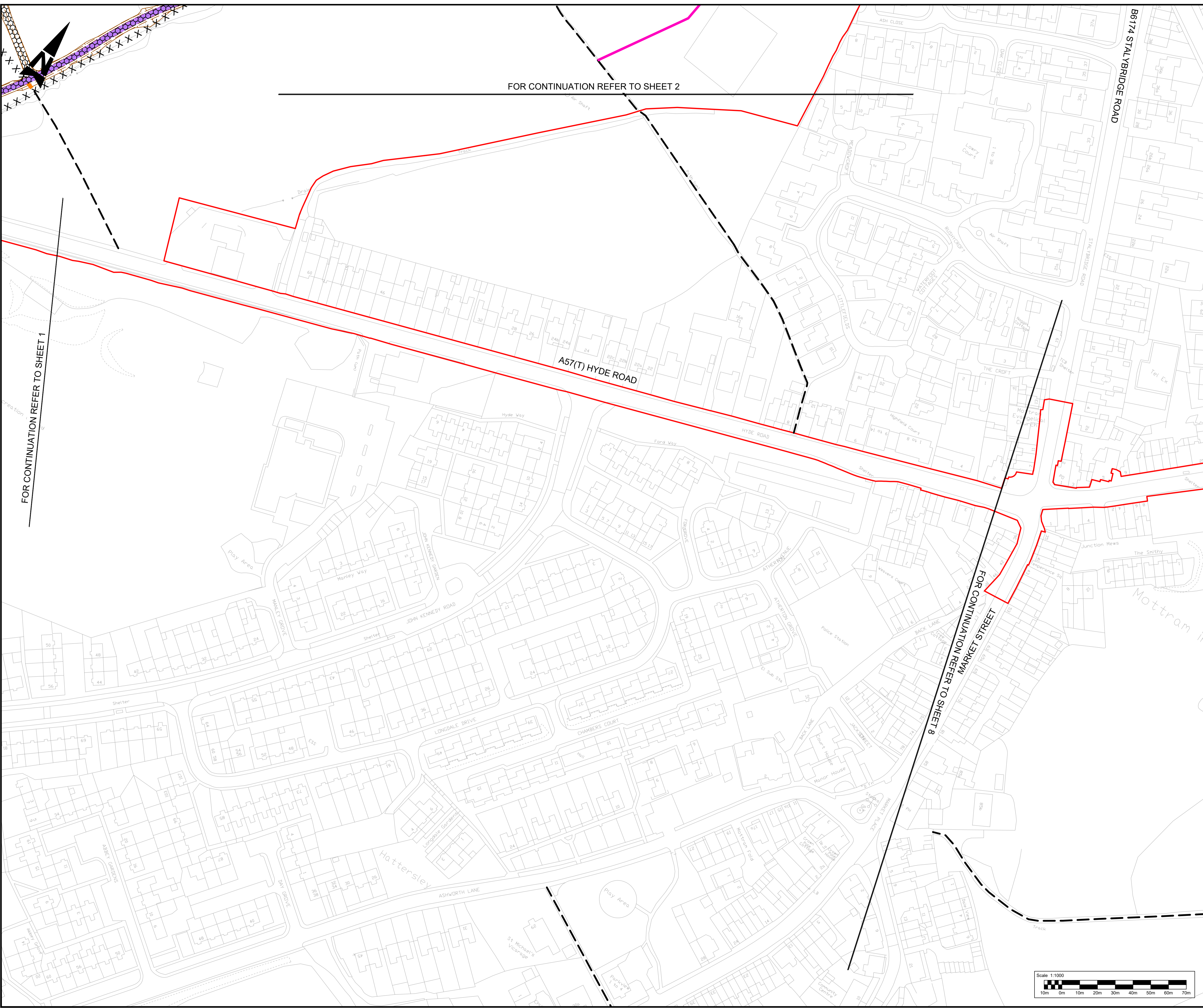

FOR CONTINUATION REFER TO SHEET 2

FOR CONTINUATION REFER TO SHEET 1

FOR CONTINUATION REFER TO SHEET 8

Notes

- These plans should be read in conjunction with Schedules 3 and 4 of the Development Consent Order (application document reference TR010034/APP/3.1).

Legend:

- Local Authority boundary
- Development Consent Order (DCO) boundary
- Scheme layout (shown for illustrative purposes)
- Existing highways to be stopped up
- Private means of access to be stopped up
- New/alterd private means of access
- Existing Public Right of Way (PRoW)
- PRoW or footway/cycleway to be stopped up/extinguished
- New or diverted bridleway
- New or diverted footway
- New or diverted footpath
- New non-segregated footway/cycle track
- New private means of access to maintain ecology mitigation

8/2 Start/End point of highway / right of way to be improved, diverted, created, stopped up or extinguished

1/a New signal controlled non-motorised user crossing

A Existing private means of access to be stopped up

9/i Other private means of access to be altered

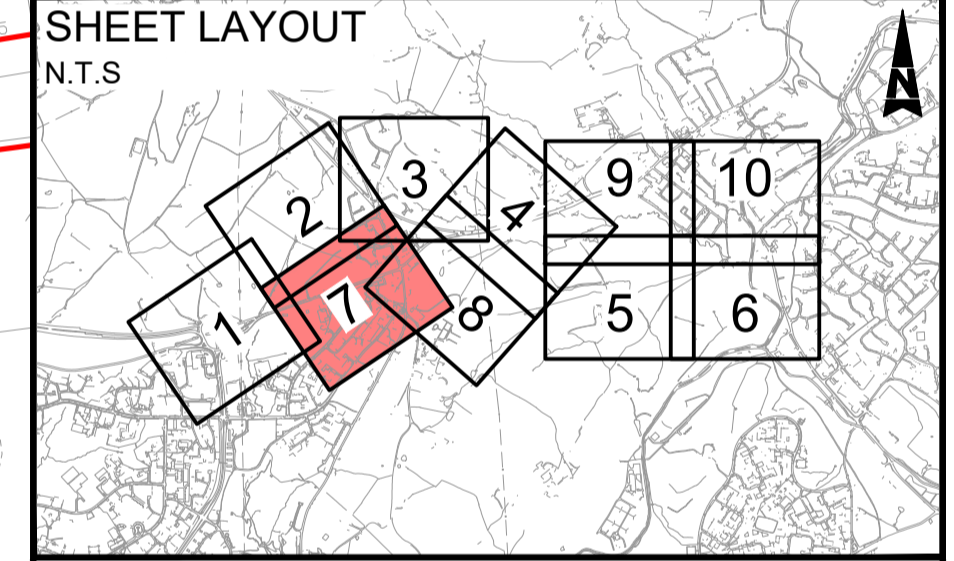

This map is based on Ordnance Survey material with the permission of Ordnance Survey on behalf of the Controller of Her Majesty's Stationary Office. © Crown copyright. Unauthorised reproduction infringes Crown copyright and may lead to prosecution or civil proceedings. Highways England 100030649, 2021.

Description	Status	Revision	Issue Date

DCO APPLICATION			
Status	A4	Revision	P01
Issue Date	14/05/21		

Drawing Suitability	DCO APPLICATION	Status	A4
---------------------	-----------------	--------	----

Client

Scheme Name
A57 LINK ROADS

Drawing Title
**STREETS, RIGHTS OF WAY AND ACCESS PLANS
REGULATION 5(2)(K)
SHEET 7 OF 10**

PINS Ref No: TR010034/APP/2.4

Drawing Number	HE551473	Originator	BBA	Volume	LDC
Scheme	A57_AL_SCHEME	Type	DR	Role	ZL
Location		Number	020407		
Scale:	1:1000 @ A1	Original Size:	A1	Rev:	P01

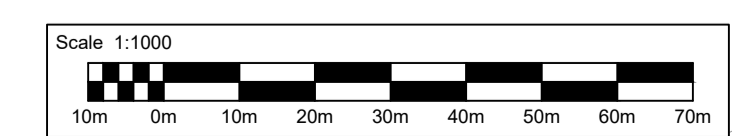

DO NOT SCALE

Millimetres
0 10 100

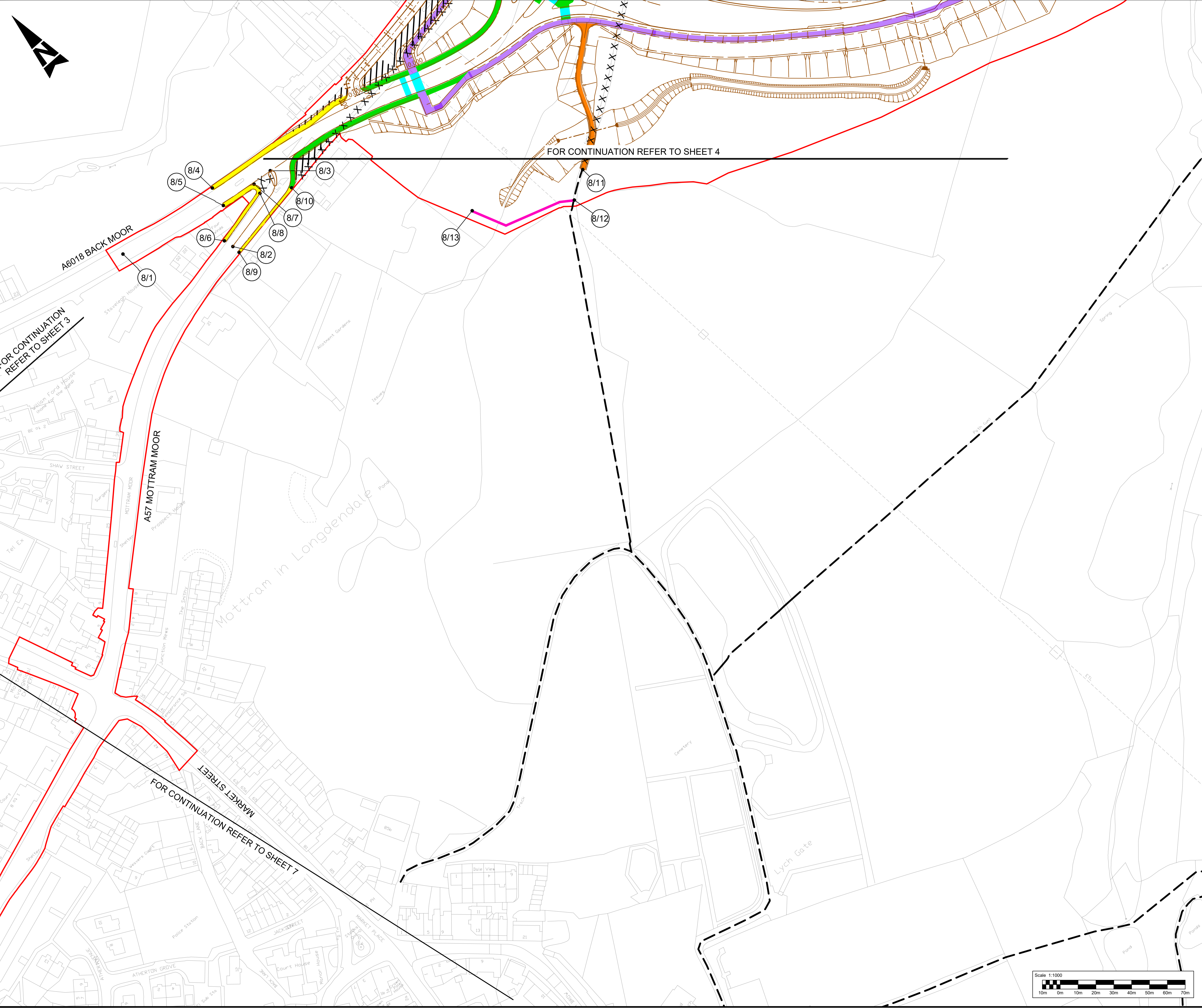

Notes

1. These plans should be read in conjunction with Schedules 3 and 4 of the Development Consent Order (application document reference TR010034/APP/3.1).

Legend:

- Local Authority boundary
- Development Consent Order (DCO) boundary
- Scheme layout (shown for illustrative purposes)
- Existing highways to be stopped up
- Private means of access to be stopped up
- New/alterd private means of access
- Existing Public Right of Way (PRoW)
- PRoW or footway/cycleway to be stopped up/extinguished
- New or diverted bridleway
- New or diverted footway
- New or diverted footpath
- New non-segregated footway/cycle track
- New private means of access to maintain ecology mitigation
- Start/End point of highway / right of way to be improved, diverted, created, stopped up or extinguished
- New signal controlled non-motorised user crossing
- Existing private means of access to be stopped up
- Other private means of access to be altered

FOR CONTINUATION REFER TO SHEET 3

FOR CONTINUATION REFER TO SHEET 4

FOR CONTINUATION REFER TO SHEET 7

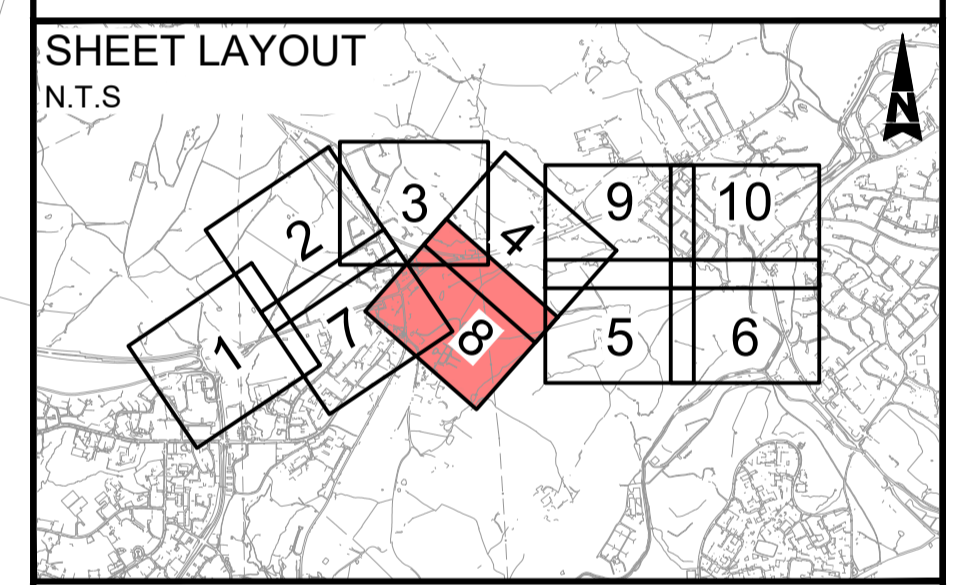

This map is based on Ordnance Survey material with the permission of Ordnance Survey on behalf of the Controller of Her Majesty's Stationary Office. © Crown copyright. Unauthorised reproduction infringes Crown copyright and may lead to prosecution or civil proceedings. Highways England 100030649, 2021.

Description	Status	Revision	Issue Date
DCO APPLICATION	A4	P01	14/05/21

Drawing Suitability: **DCO APPLICATION** Status: **A4**



Scheme Name	A57 LINK ROADS		
Drawing Title	STREETS, RIGHTS OF WAY AND ACCESS PLANS REGULATION 5(2)(K) SHEET 8 OF 10		
PINS Ref No:	TR010034/APP/2.4		
Drawing Number	HE551473	Originator	BBA
Scheme	A57_AL_SCHEME	Volume	LDC
Location	DR	Type	ZL
Scale:	1:1000 @ A1	Original Size:	A1
Rev:	P01	Number	020408

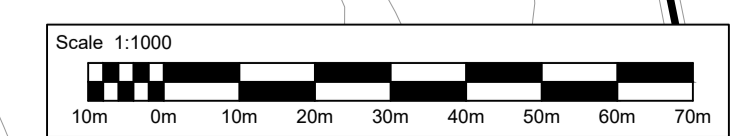

© Crown copyright (2019).

You may re-use this information (not including logos) free of charge in any format or medium, under the terms of the Open Government Licence. To view this licence:

visit www.nationalarchives.gov.uk/doc/open-government-licence/

write to the Information Policy Team, **The National Archives, Kew, London TW9 4DU**,
or email psi@nationalarchives.gsi.gov.uk.

Printed on paper from well-managed forests and other controlled sources.

Registered office Bridge House, 1 Walnut Tree Close, Guildford GU1 4LZ
Highways England Company Limited registered in England and Wales number 09346363

